

Independent Cottages at The Village

A great alternative to purchasing a condo, our Independent Living Cottages offer residents the freedom and privacy of their own house, the added comfort of a secure environment, all the benefits of a social lifestyle, and future access to higher levels of medical care.

Our 24 colonial-style homes are available in three floor plans. Each style includes two bedrooms, two full baths, a spacious kitchen, dining area, great room, utility room, four-season solarium, outdoor patio and an attached single car garage.

Cottage Living Includes:

- ✓ All inside and outside maintenance
- ✓ All appliances
- ✓ Landscaping and yard care
- ✓ Property taxes
- ✓ Insurance on the structure
- ✓ Alarm system and security
- ✓ Emergency call system
- ✓ Priority placement in other living options
- ✓ Refuse services
- ✓ Snow removal
- ✓ Standard and basic cable
- ✓ Village programs
- ✓ Water

Also Available:

- ✓ Fitness room
- ✓ Beauty salon/barber shop
- ✓ Postal services
- ✓ Dining room meals
- ✓ Computer lounge
- ✓ Banking services
- ✓ General store
- ✓ Scheduled outings
- ✓ Worship services
- ✓ Billiard Room

Cottage Living Rates:

The accommodations fee listed to the right is due in full before occupancy. The monthly maintenance fee commences upon occupancy.

When a resident leaves a Cottage, the resident or their estate receives a 75 percent refund of the original fee paid after the Cottage has been remarketed.

If a resident must move out of the Cottage due to illness or death during the first two years, only \$10,000 per year will be withheld and the remaining amount will be refunded after the Cottage is remarketed.

Please note: Due to the limited number of Cottages, a waiting list has been established. In order to be placed on the list, a completed application along with a nonrefundable application processing fee of \$200/single or \$275/couple must be received.

Please turn the page over to view the Cottage Floor Plans.

*The square footage listed is approximate and was provided by the architects. The square footage will vary from Cottage to Cottage and the number may include measurements from outside wall to outside wall and additional outside areas.

All rates and fees are effective January 1, 2017 and are subject to change.

165 Highbluffs Blvd., Columbus, OH 43235 (614) 846-6076 www.wcv.org

Cottage Style	Size	Fee
The Mt. Vernon (A Unit)	*1,508 Sq. Ft.	\$163,712
The Monticello (B Unit)	*1,721 Sq. Ft.	\$174,958
The Williamsburg (C Unit)	*1,798 Sq. Ft.	\$182,992
MAINTENANCE FEE -		\$707 PER MONTH

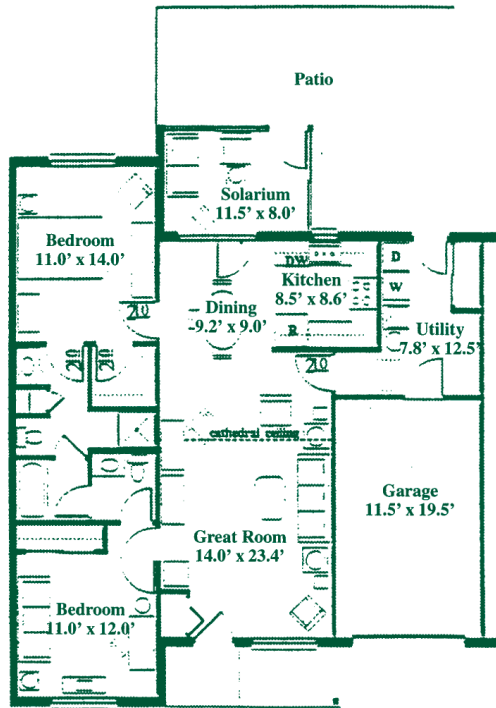

(A) FLOOR PLAN
Scale: 1/8"=1'.0"

1508 Sq. Ft.

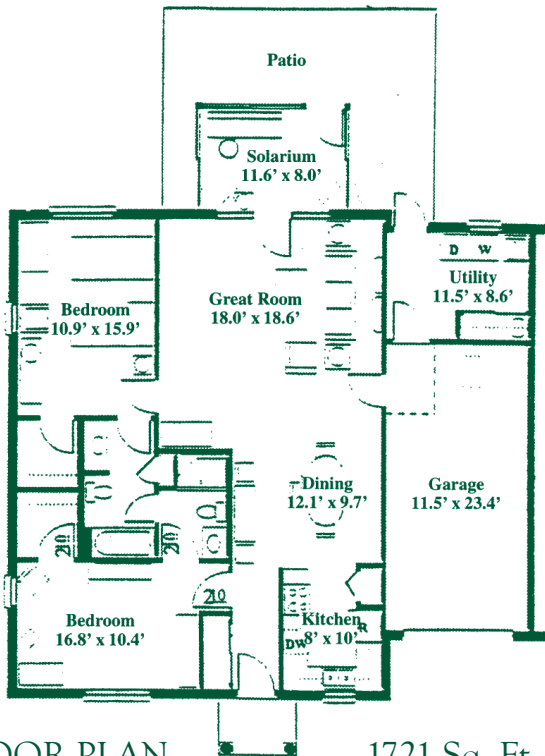

(B) FLOOR PLAN
Scale: 1/8"=1'.0"

1721 Sq. Ft.

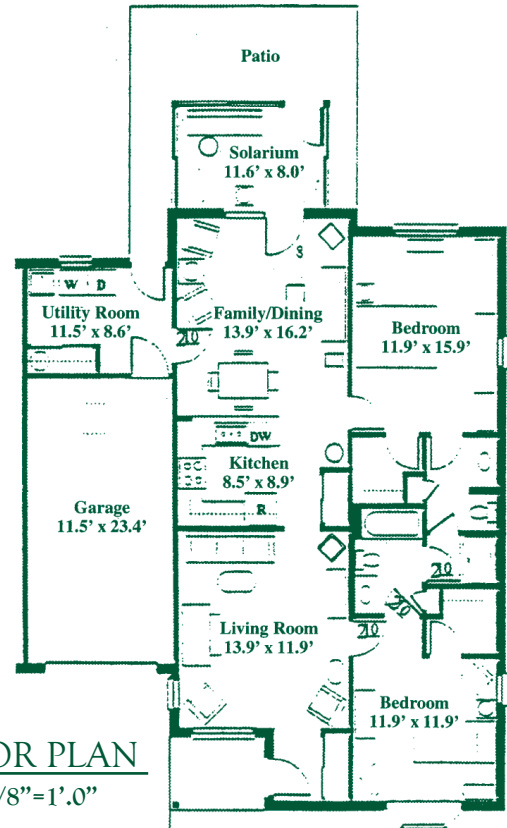

(C) FLOOR PLAN
Scale: 1/8"=1'.0"

1798 Sq. Ft.